

# Z-Line Shelving System



**tennsco**  
SYSTEMS FOR SUCCESS

## Z-Line Shelving

*When it comes to value without compromising performance you're talking about Z-Line shelving. Its fastening mechanism combined with a versatile array of components means it fits all your storage needs. The interlocking keyhole design not only makes installation fast and easy but eliminates the need for clips, gussets, sway braces or other hardware necessary with conventional shelving. Without these obstacles you have completely free access from all sides of the unit.*

*Z-Line's adaptability makes it ideal for any size storage requirement. Its interchangeable componentry means it can be configured for single width shelving applications or spans up to 96" wide. It's a multifaceted system that affordably solves all your storage needs.*

## Z-Line Features

### Exceptional Strength



Double rivet design and keyhole slots form a rigid framework. Combine heavy gauge steel posts, shelf supports and angle beams and you have a shelving system that easily stands up to any industrial application.

### Easy Assembly



Assembly goes smoothly and quickly with Z-Line's snap-in rivet and keyhole design that eliminates the need for fasteners or braces.

### Unobstructed Accessibility



Because the Z-Line design eliminates structural bracing, items can be loaded and unloaded from either the side, front or back of the unit for maximum versatility.

### The Universal Storage Solution



Standardize your storage solutions throughout your organization by using Z-Line's interchangeable components for either your heavy-duty applications or where total weight requirements are not as demanding.

# Z-Line Applications

## Handles Your Toughest Loads

Unlike other shelving offerings, Z-Line is designed to handle loads up to 2000 lbs. per shelf. Plus it takes the tough handling found in warehouses or industrial storage areas.



## Archive & Box Storage

Z-Line is ideal for handling archived office materials like accounting records, computer printouts, etc. Standard sized storage boxes fit optimally on Z-Line shelves to maximize space.



## Creative Storage Capabilities

Z-Line is one of the most flexible and affordable shelving systems available. Use your imagination in creating not only customized storage but also work stations, equipment stands, shipping stations, cutting tables, tire racks, hang racks and more.



**tennsco**

SYSTEMS FOR SUCCESS

## Z-Line Shelving

### Easy Assembly

Two way keyhole slots and snap-in rivet design make installation a snap. No clips, sway braces, corner gussets or additional hardware needed.

### Structural Integrity

Positive rivet connection combines with 14 gauge angle post to make a rigid framework ideal for mezzanine or high density mobile shelving.

### Long Spans

Configure units up to 96" wide by 60" deep with Z-Line's channel beams.

### Added Reinforcement

Handle extra heavy loads with extra center support.



### Flexible Design

Shelves adjust in 1½" increments for optimum flexibility.

### Strength Without Compromise

Standard 14 gauge double rivet beam has 2¾" profile and handles loads up to 2000 lbs. Or choose our optional 3¼" profile channel beam for even greater load capacity.

### Low Profile Shelf Support

Maximize shelf openings with thin but strong shelf supports.

### Strong, Economical Shelves

Industrial grade particle board shelves hold up to the toughest applications— at an affordable price.

### Tall, Upright Posts

Upright posts are available in lengths up to 181½".

# Post Options

## Post Options

Match posts with your needs: Use HUR posts for your most demanding applications. Use EUR for light or medium weight applications and in conjunction with ZTP posts. Use ZTP as an intermediate common "T" post.



**HUR**  
Heavy Upright Post



**EUR**  
Standard Upright Post



**ZTP**  
Intermediate Upright Post

# Shelf Options



## Particle Board Decking

Industrial grade  $\frac{5}{8}$ " particle board decking provides a sturdy work surface that is both strong and economical.



## Wire Decking

Select wire decking for better visibility of items. Meets Factory Mutual fire codes.

# Support Options



## Low Profile Support Options

Maximizes shelf openings in light to medium duty support applications. Available in 14 or 11 gauge steel. Load capacities range from 400 to 1000 lbs., depending upon steel gauge and shelf size.



## Medium Profile Support Options

Special V-beam design provides heavy-duty support at an economical price. Available in 16 or 14 gauge steel. Load capacities range from 600 to 1500 lbs., depending upon steel gauge and shelf size.



## Wide Profile Shelf Supports

Heavy-duty  $2\frac{3}{4}$ " high beam to laterally support decking in longer spans. For load capacities ranging from 900 lbs. to 1500 lbs., depending upon shelf size.



## Channel Beams

Extra heavy-duty  $3\frac{1}{4}$ " high beam for maximum strength. Supports spans 48" and longer. Load capacities range from 1000 lbs. to 2500 lbs., depending upon shelf size.

**tennsco**

SYSTEMS FOR SUCCESS

# Z-Line Accessories



## Front to Back Shelf Deck Support

For added support for decking on long spans. Used with wide profile shelf supports and Channel Beams.



## Medium Profile Front to Back Shelf Supports

Added support on long spans of medium profile shelf supports. Snap-in design for easy installation.



## Cross Aisle Ties

Cross aisle ties stabilize rows of shelving by tying them together across the aisle.



## Adjustable Aisle Ties

Links units across an aisle in distances from 48" to 84"



## Tie Plate

Connect two units back-to-back or side-to-side while maintaining spacing for rivet head clearance.



## Wall Tie

Connects a unit to the wall with a 9" spacing. Provides additional stability for tall units.



## Post Splice Angle

Splices two upright posts together.

## Using Z-Line with Mezzanines

Z-Line can be expanded to mezzanine storage for even more efficient storage. Send us your requirements and we'll custom design a system perfectly suited to your specific needs.

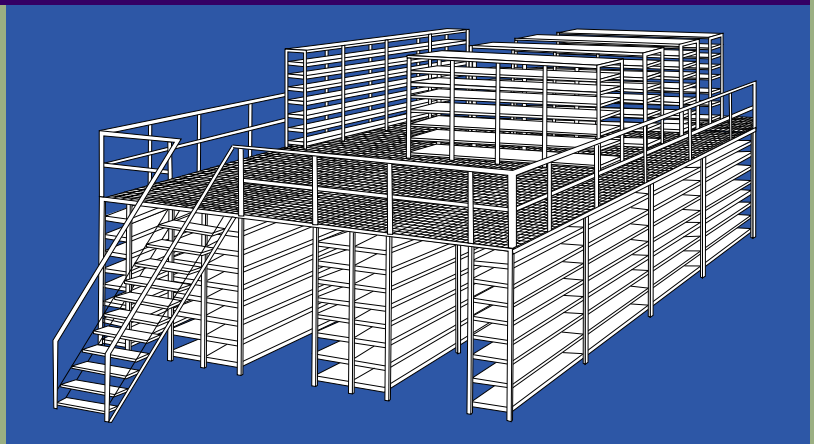

# Z-Line Specialty Units

## Record Archive



Rack designed to hold record storage boxes for archival purposes. May be ordered with or without particle board decking to allow you to use your own shelf surface.

## Record Archive with Steel Angle Supports



Special unit that allows record storage boxes to slide in and out of individual channels for complete organization. Available in a single or double entry unit.

## Tire Rack



Conveniently stores tires for easy access and display. Vertical storage allows maximization of available floor space. Available in a single or double entry unit.

**tennsco**

SYSTEMS FOR SUCCESS

All Tennsco Z-Line Shelving is painted with a tough, long lasting, enamel finish to ensure years of lasting beauty. Choose from three standard finishes.



Sand



Light Grey



Medium Grey

Finishes shown above are only representative of the actual finishes. If greater accuracy is required contact your local Tennsco dealer for additional information.

#### A WORD ABOUT TENNSCO

Tennsco Corp., headquartered in Dickson, Tennessee, began operations in 1962. Today, Tennsco is an industry leader with over 1.4 million square feet of manufacturing and warehouse space in six facilities. Tennsco offers a wide variety of filing and storage systems, steel office furniture, industrial and institutional shelving, lockers and shop equipment.

For additional information on other Tennsco products, contact:

**tennsco**  
SYSTEMS FOR SUCCESS

*Mailing Address:*  
P.O. Box 1888  
Dickson, TN 37056-1888

*Shipping Address:*  
201 Tennsco Drive  
Dickson, TN 37055

(615) 446-8000 • (800) 251-8184 • Facsimile (800) 722-0134  
Internet: [www.tennsco.com](http://www.tennsco.com) • E-mail: [info@tennsco.com](mailto:info@tennsco.com)